

## Weigh hopper KTW

for throughput measurement in extrusion  
free-flowing pellets, regrind or powder



### Range of weigh hoppers

- 3 ... 50 Liter

### Throughput range

- < 1.0 ... 2000 kg/h

### Load cell

- HBM strain gauge
- compensation of torque and temperature

### Mechanical construction

- stainless steel and aluminium
- polished shape

### Outstanding features

- easy to clean
- robust mechanics
- safe operation
- accurate gauging

Weigh hopper for pellets

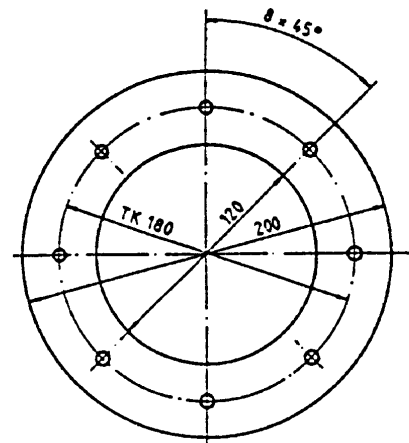
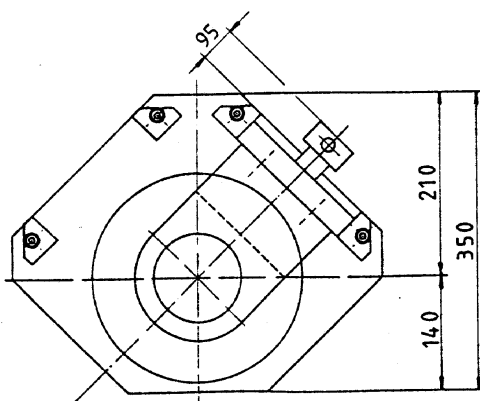
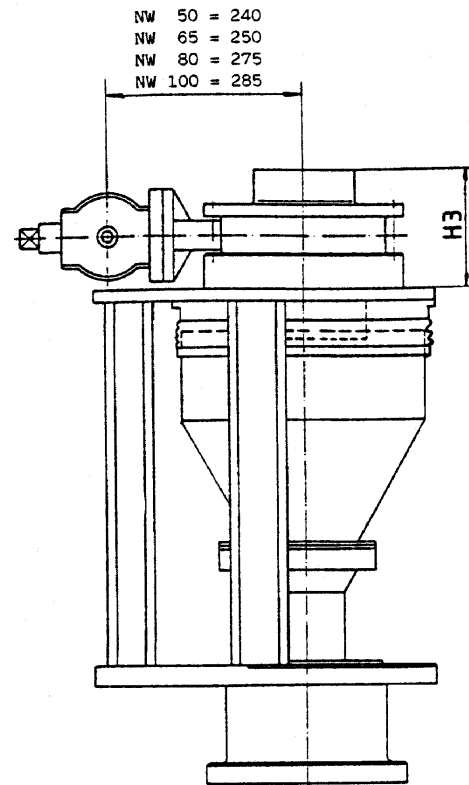
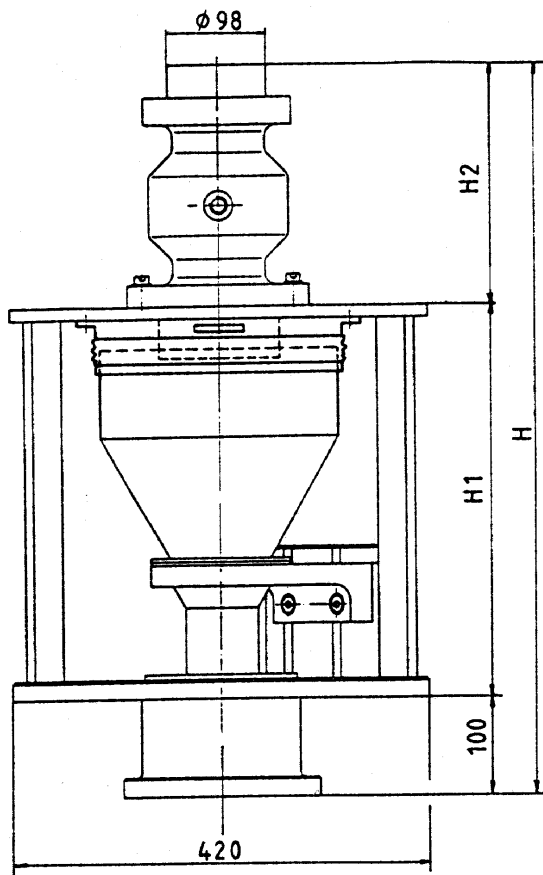

Range of weigh hoppers for pellets											
KTW	3L	4,5L	6,5L	9L	12L	15L	18L	30L	36L	40L	50L
Throughput, typ. [kg/h]	100	150	200	300	400	500	600	1000	1200	1200	1500
Input diameter [mm]	50	65	65	80	100	100	100	100	100	125	125
pinch valve high H [mm]	652	700	729	828	951	1003	1079	1153	1184	1222	1222
butterfly valve high H [mm]	551	566	595	644	721	773	849	923	954	1222	1222

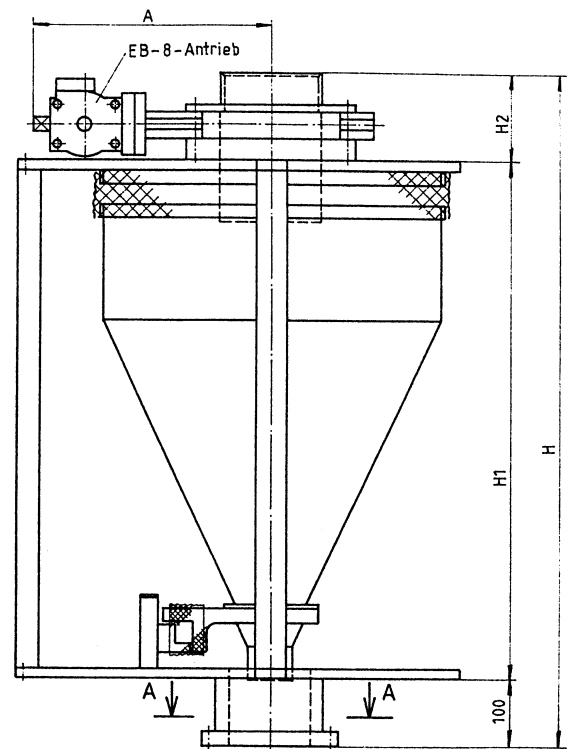
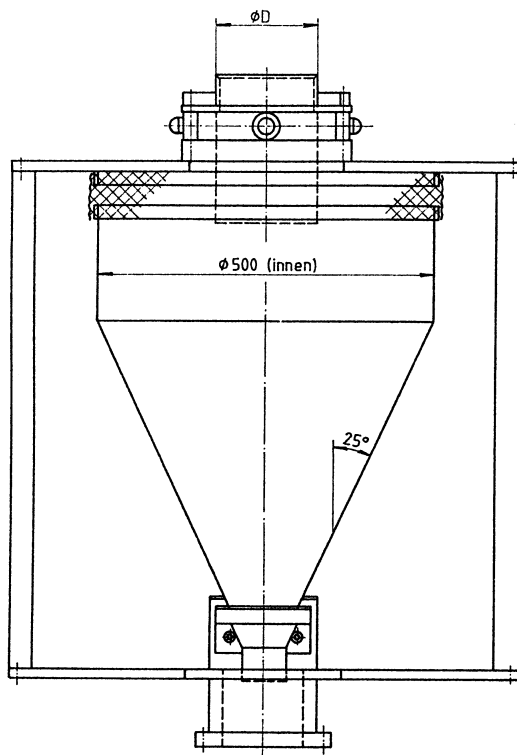

Schnitt A - A

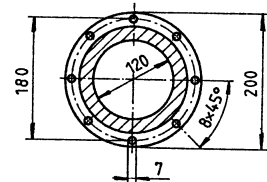
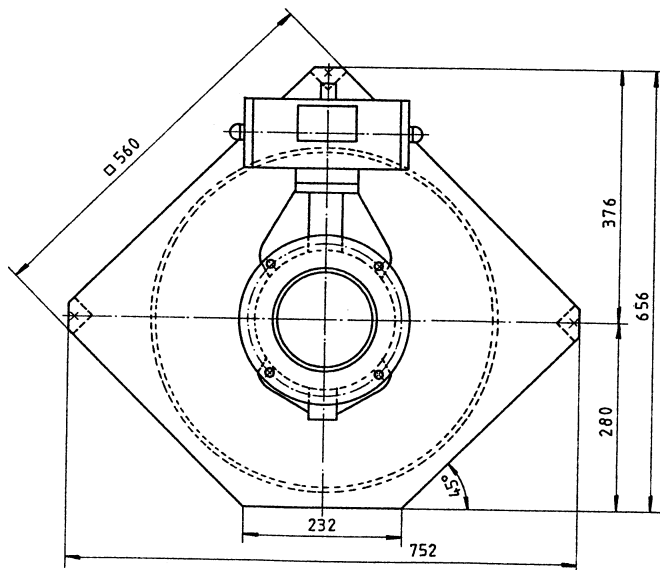

Dimensions of 40L/50L weigh hoppers:

Volume Valve	40L	40L	50L	50L	50L
	DN100	DN125	DN100	DN125	DN150
A	315	327	315	327	350
D	98	123	98	123	148
H1	720	720	770	770	770
H2	110	125	110	125	125
H	930	945	980	995	995

Weigh hopper for powder and regrind:

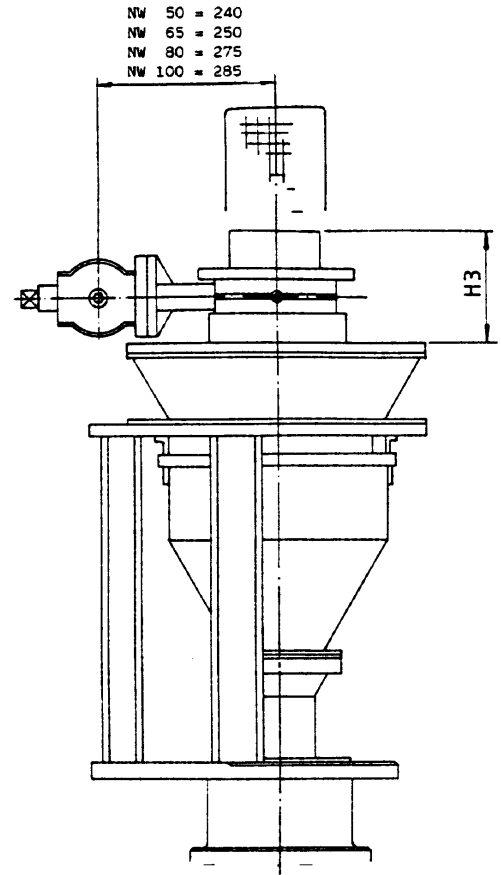
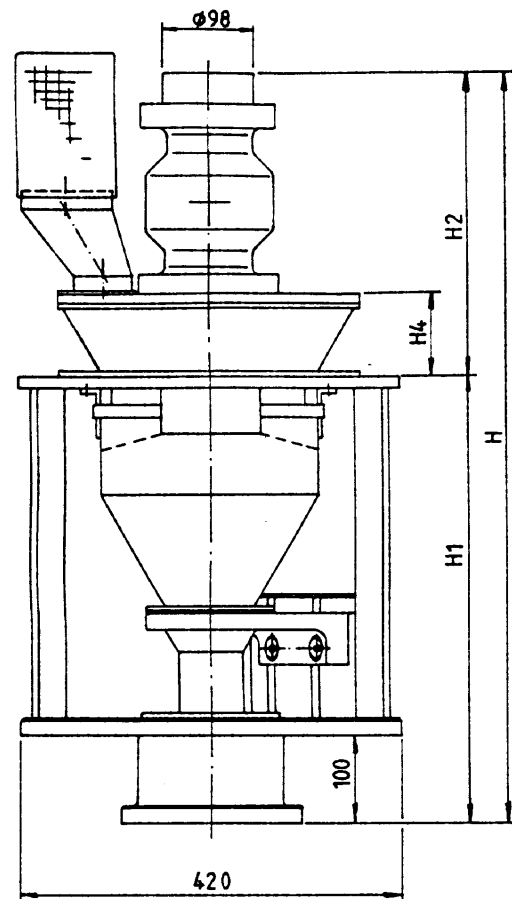

NW 50 = 240  
 NW 65 = 250  
 NW 80 = 275  
 NW 100 = 285

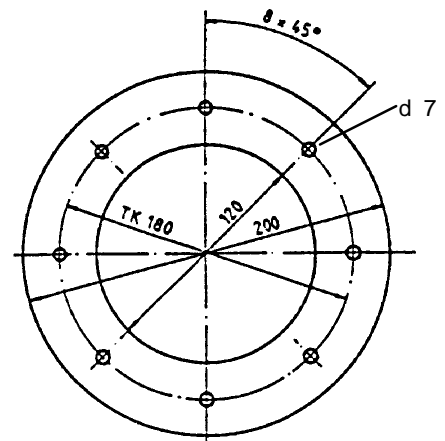
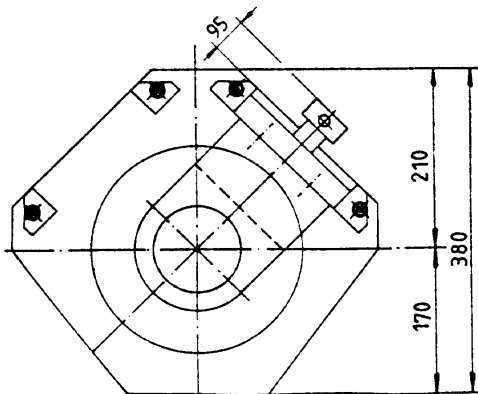

Weigh hopper for powder and regrind											
KTW	3L	4,5L	6,5L	9L	12L	15L	18L	30L	36L	40L	50L
Throughput, typ. [kg/h]	100	150	200	300	400	500	600	1000	1200	1200	1500
Valve diameter [mm]	50	65	65	80	100	100	100	100	100	125	125
pinch valve high H [mm]	652	700	729	828	951	1003	1079	1153	1184	1222	1222
butterfly valve high H [mm]	551	566	595	644	721	773	849	923	954	1222	1222

**Dimensional details:**

Weighing hopper inlet	flexible tube diameter 100mm or 150mm, length: 800...1000 mm
Ebro butterfly valve	H3 106 mm H4 72 mm
Weigh hopper outlet:	Aluminium plate or turned round piece; high: 20 .... 200 mm Dimensional drawing of the extruder inlet is required to design the adapter

**Specification:****Throughput / Load cell**

Throughput range	0,1 ... 1,25 * of typical extruder throughput
Accuracy	0,5% on Bolder automation products
Max. temperature	50°C
Number of cells	1
Gauge connector	14S-6 MIL-C-5015 (Amphenol)

**Valves**

Pinch valve		Ebro- valve	
Max. Material temperature	60°C	Max. Material temperature	130°C
Max. pressure	2,5 bar	Max. pressure	8 bar
working pressure	1,5 ... 2 bar	working pressure	4,5 ... 6 bar
Air consumption	1,5 m³/h	Air consumption	1,3 m³/h
Connector	DIN 43650-B	Connector	DIN 43650
		Voltage supply	24VDC, 3W or 230VAC, 5W

**Ordering details:****Weigh hopper KTW - Material - Volume - Valve – Valve supply - Window**

Material	<b>G</b> pellets <b>M</b> regrind <b>P</b> powder
Volume	<b>3L, ..., 50L</b>
Valve	<b>Q</b> pinch valve <b>E</b> Ebro valve
Voltage supply	<b>V24</b> 24VDC <b>V230</b> 230VAC
Window	<b>x</b> no window <b>W</b> window