

Weighing hoppers

KTW

for granules with pinch valve
for granules with Ebro- butterfly valve
for powder and regrind with Ebro- butterfly valve



Range of weighing hoppers

- 3 ... 50 liters

Massflow range

- < 1.0 ... 2000 kg/h

Load cell

- HBM strain gauge
- torque and temperature compensation

Mechanical construction

- stainless steel and aluminium
- polished shape

Outstanding features

- easy to clean
- robust mechanics
- safe operation
- accurate gauging

Weighing hopper for granules:

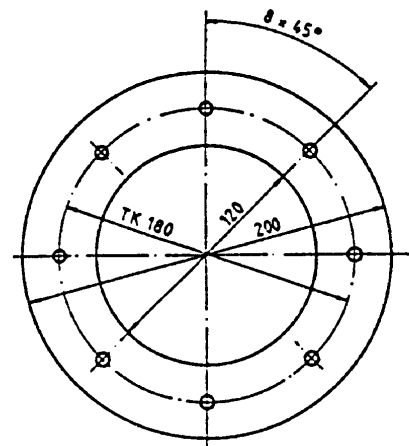
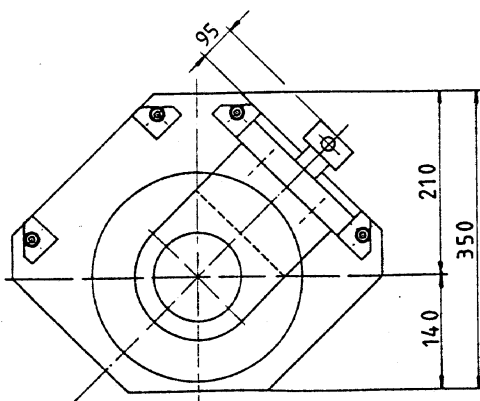
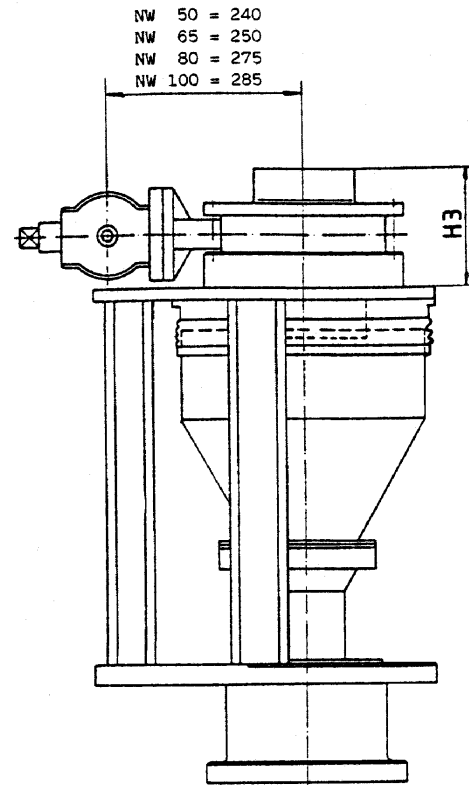
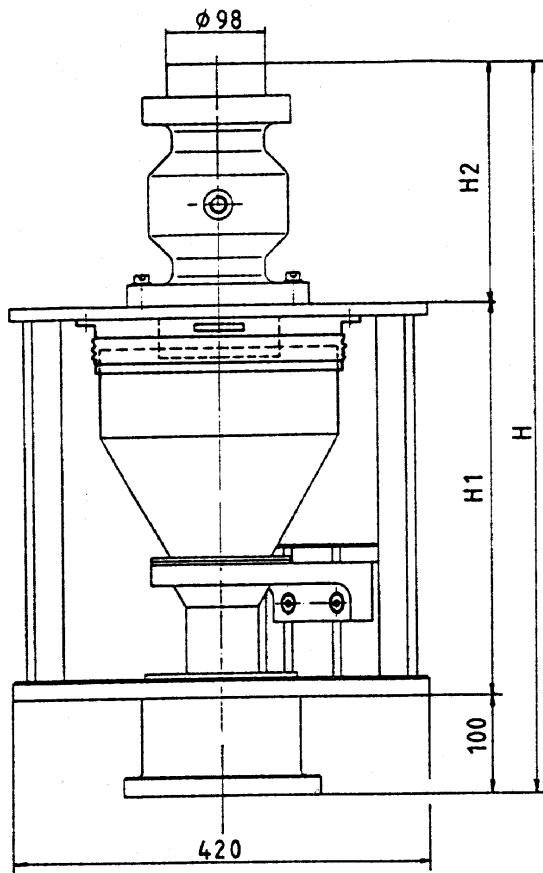

Granules weighing hopper										
Conpro KTW	3L	4,5L	6,5L	9L	12L	15L	18L	30L	36L	Bulk density= 0,6kg/l
Massflow, typical [kg/h]	100	150	200	300	400	500	600	1000	1200	
Input diam [mm]	50	65	65	80	100	100	100	100	100	
Pinch valve										
Height H [mm]	652	700	729	828	951	1003	1079	1153	1184	
Ebro valve										
Height H [mm]	551	566	595	644	721	773	849	923	954	

Weighing hopper for powder and regrind:

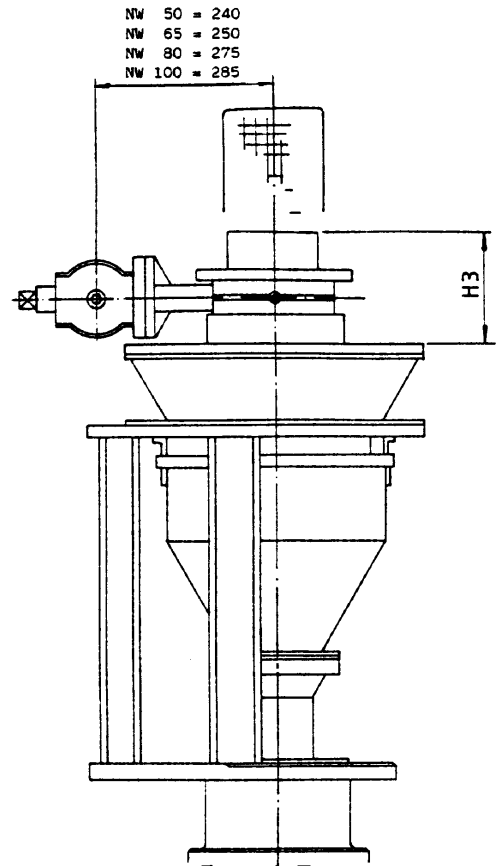
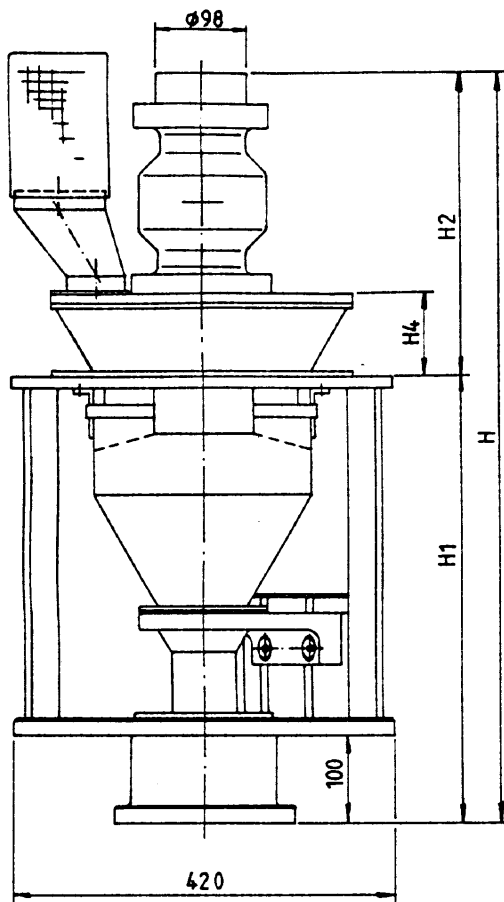

NW 50 = 240
 NW 65 = 250
 NW 80 = 275
 NW 100 = 285

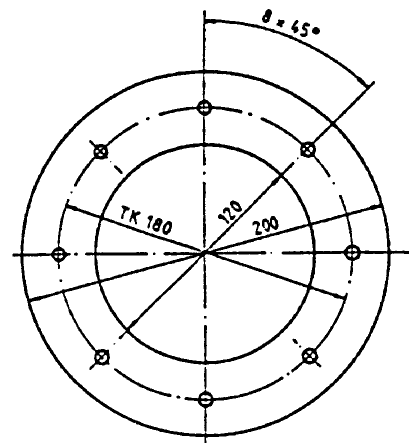
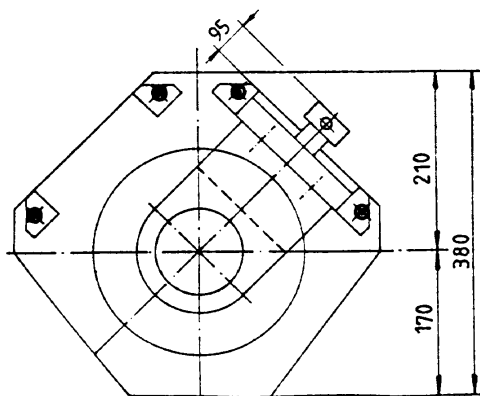

Powder and regrind weighing hopper										
Conpro KTW	3L	4,5L	6,5L	9L	12L	15L	18L	30L	36L	Bulk density= 0,6kg/l
Massflow, typical [kg/h]	100	150	200	300	400	500	600	1000	1200	
Input diam [mm]	50	65	65	80	100	100	100	100	100	
Pinch valve										
Height H [mm]	727	775	804	903	1026	1078	1154	1228	1259	
Ebro valve										
Height [mm]	626	641	670	719	796	848	924	998	1029	

Dimensional details:

Weighing hopper inlet: flexible tube diameter: 100mm, length: 100 ... 800 mm

Ebro butterfly valve:	H3	106 mm
Pinch valve DN 50	H2	207 mm
DN 65	H2	240 mm
DN 80	H2	290 mm
DN 100	H2	336 mm
	H4	72 mm

Weighing hopper outlet: Aluminium plate or turned round pipe; height: 20 200 mm
Dimensional drawing of the extruder inlet is required to design the adapter

Specification:

Massflow/ Weighing cell

Massflow range	0,1 ... 1,25 * typical massflow
Accuracy class	0,5% on EUROTHERM/BOLDER 950 Gravimetric Controller
Ambient temperature	50°C
Nr. of gauges (3L ... 18L)	1
Nr. of gauges (30L, 36L)	2
Gauge connector	6 pin. Hirschmann GO 6 WF or 14S-6 MIL-C-5015 (Amphenol)

Refill valve

Pinch valve

Max. temperature	60°C
Max. pressure	2,5 bar
Typical pressure	1,5 ... 2 bar
Air consumption	1,5 m³/h
Connector	DIN 43650-B

Ebro butterfly valve

Max. temperature	130°C
Max. pressure	8 bar
Typical pressure	4,5 ... 6 bar
Air consumption	1,3 m³/h
Connector	DIN 43650

Supply 24VDC, 3W or 230VAC, 5W

Ordering details:

Coding: **Conpro KTW** - material - volume - valve - valve supply - gauge connector - window
[- valve inlet diameter - conus outlet diameter - load cell]

material	G	granules
	P	powder and regrind
volume	3L, ..., 50L	see table
valve	Q	pinch valve
	E	Ebro butterfly vave
valve supply:	V24	24VDC
	V230	230VAC
gauge connector	HI	Hirschmann, GO 6 WF
	MIL	14S-6 MIL-C-5015, Amphenol
window	NoW	no window
	W	window

Contact:

BOLDER automation GmbH
Am Zehntenstein 28
D - 65549 Limburg

Tel +49-6431-98 48 0
Fax +49-6431-98 48 28

